

The View at Battersea Power Station

photography: © Rob Falconer 2010

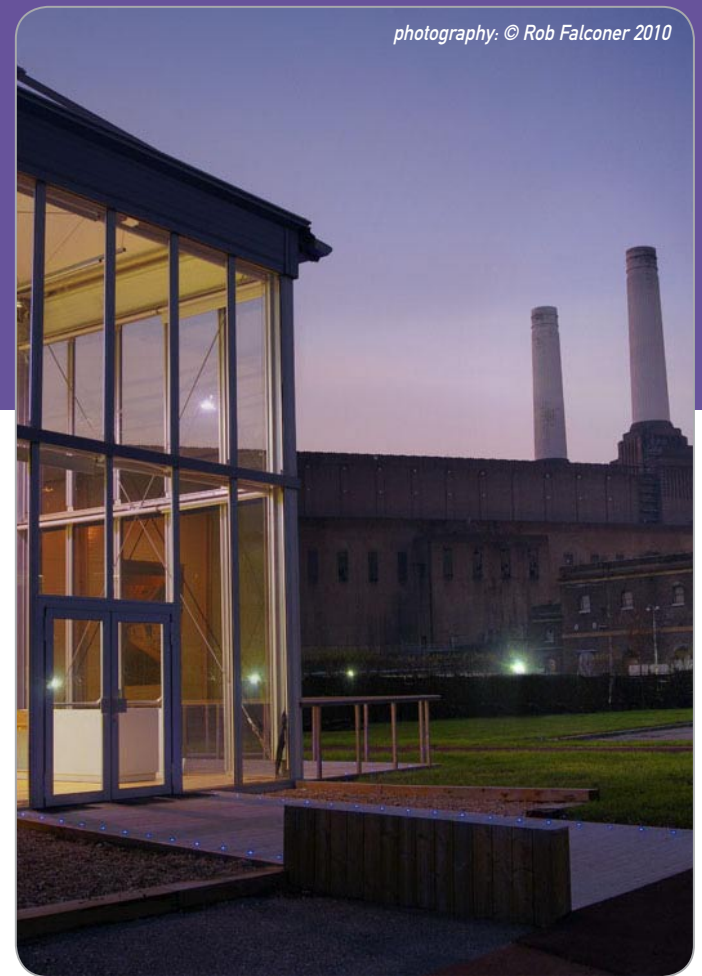

exclusively represented by
industri management office tel: 020 7269 7935
email: info@industri.uk.com

site office: Battersea Power Station,
188 Kirtling Street, London SW8 5BN

booking information for hirers

www.industri.uk.com



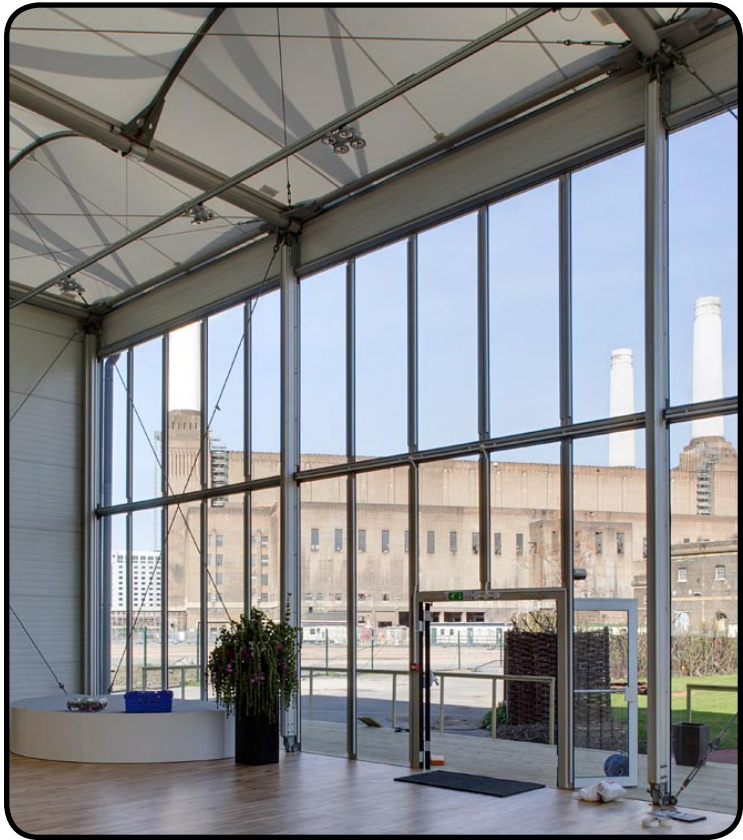

The View is one of two event spaces at Battersea Power Station and offers a fantastic panorama of one of London's most iconic buildings. The venue lends itself to corporate functions, product launches, daytime business luncheons and evening networking events. There is ample parking available as well as catering facilities and furniture for hire (including stage, lectern and stylish reception desk/bar). A decked terrace and lawn complements this stunning venue option. Available for all dry hire, public and private events.

size: 15mx20m (300 sqm/3229 sqft)
capacity: 150+ sit down, 375 standing
power/utilities: 3phase, ac/heating available

availability:
Available 7 days a week, usually until 23:00, but subject to event.

lighting:
Halogen spot/projector track system and blackout blinds available.

other utilities:
mains water supply available

insurance:
Hirer to provide: public liability of £10,000,000.00, employer's liability of £10,000,000.00.

access:
Vehicle and pedestrian access via Gate 2 on Kirtling Street.

WCS:
Designated area for temporary toilets available.

parking:
Parking spaces available for 75+ cars.

reception:
separate reception area and cloakroom available



Please contact our events team for further details.

hire type:

All event facilities are available on a dry hire basis only.

contracts:

Event facilities are hired subject to Battersea Power Station's standard licence agreement. A thorough schedule of hire will be required for each event. A standard template will be supplied and will form part of the licence agreement.

health & safety:

All hirers will be required to provide health & safety documentation for their event. A venue safety management plan is available for The View, subject to the hirer providing bespoke amendments according to event specifications.

advertising and promotion:

All hirers must submit advertising and promotional material in relation to their event for landowner approval in advance of release to the public domain.

damage deposit:

Will be required prior to any event. The value will vary depending on the event activity, length of hire and area being used.

fees:

All fees will be subject to a strict payment schedule and due in full in advance of the event.

permissions:

Planning permission and licences are required for events planned to take place on external areas of the site's Showground other than The View.



photography: © Rob Falconer 2010



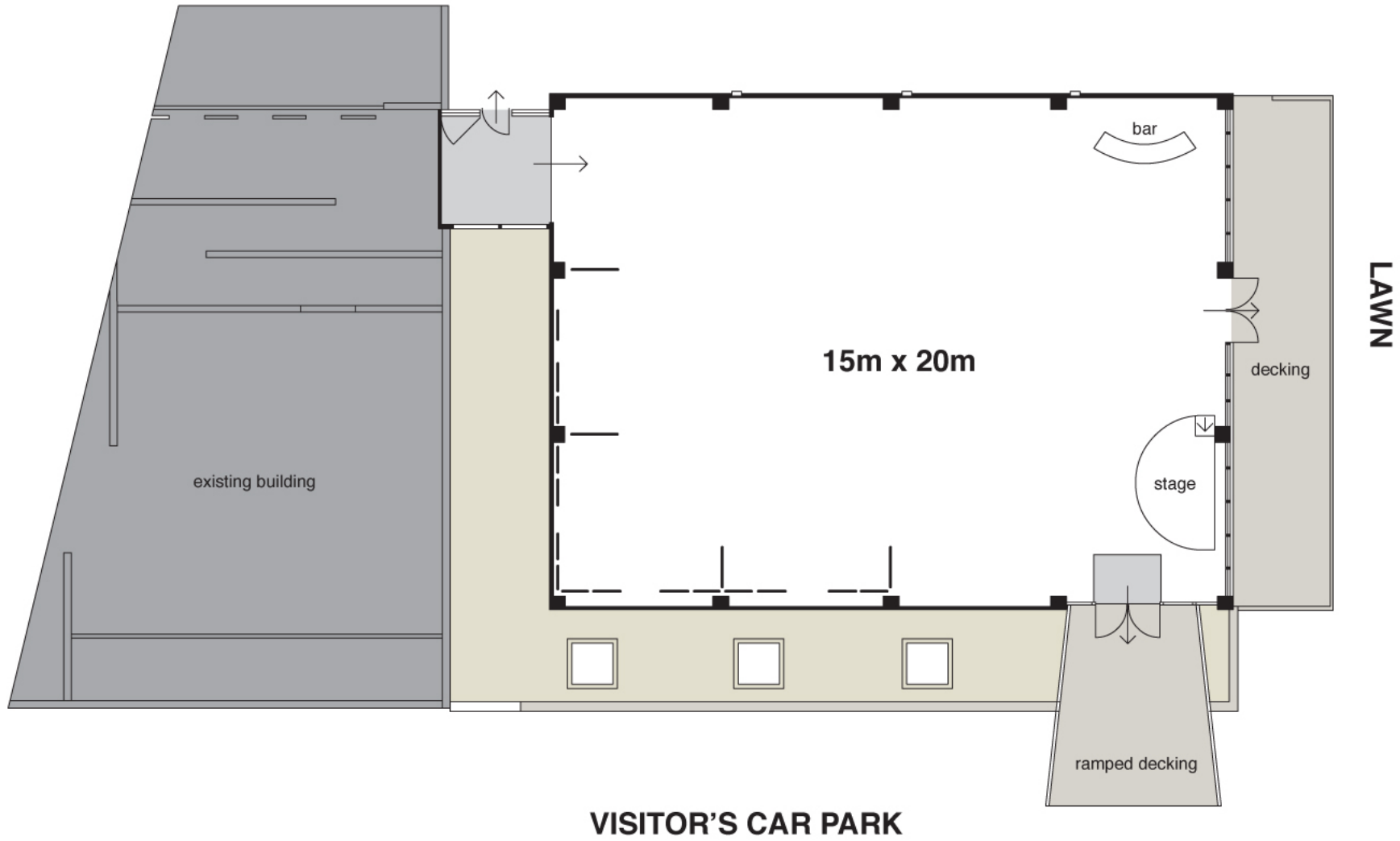

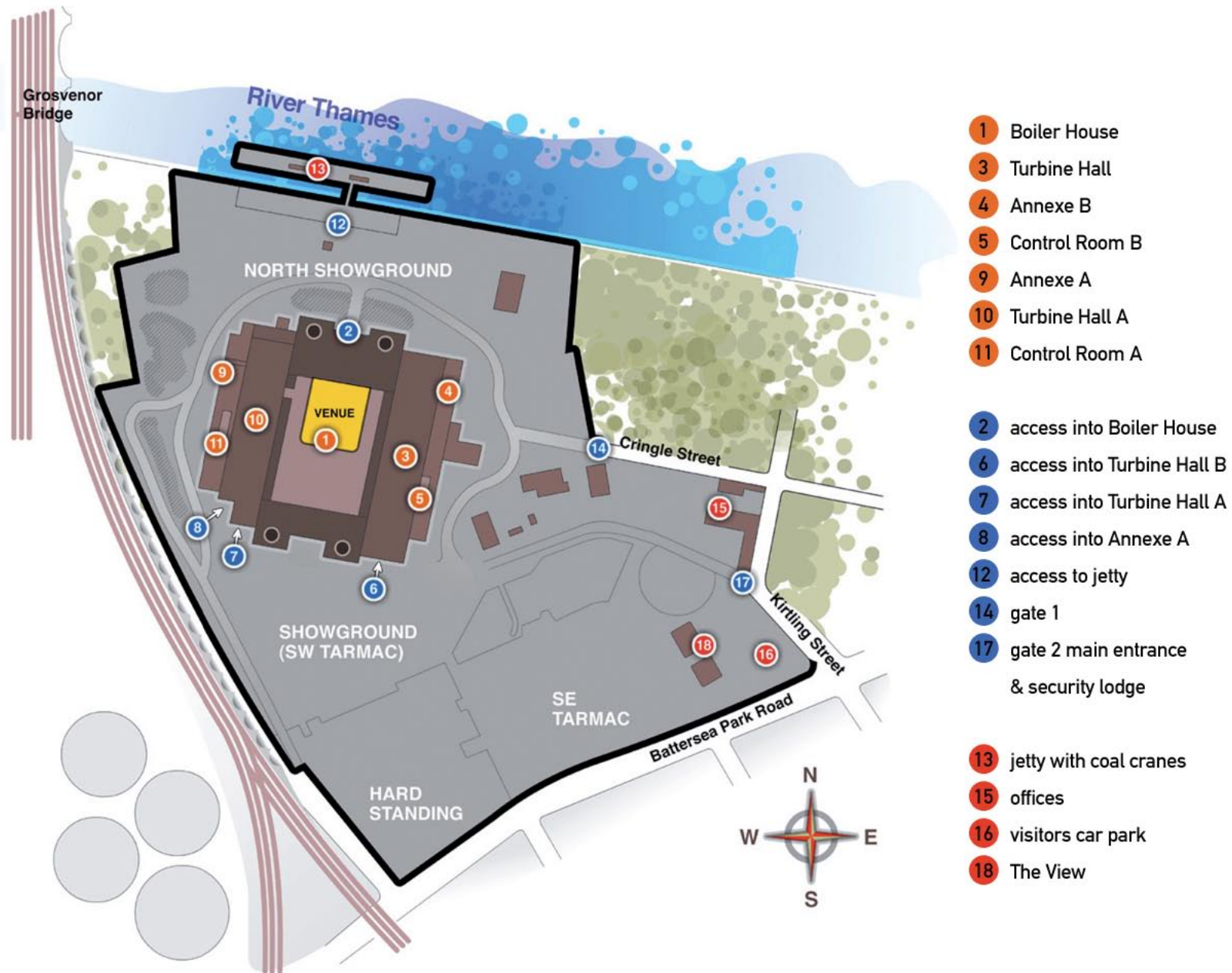

battersea power station site plan

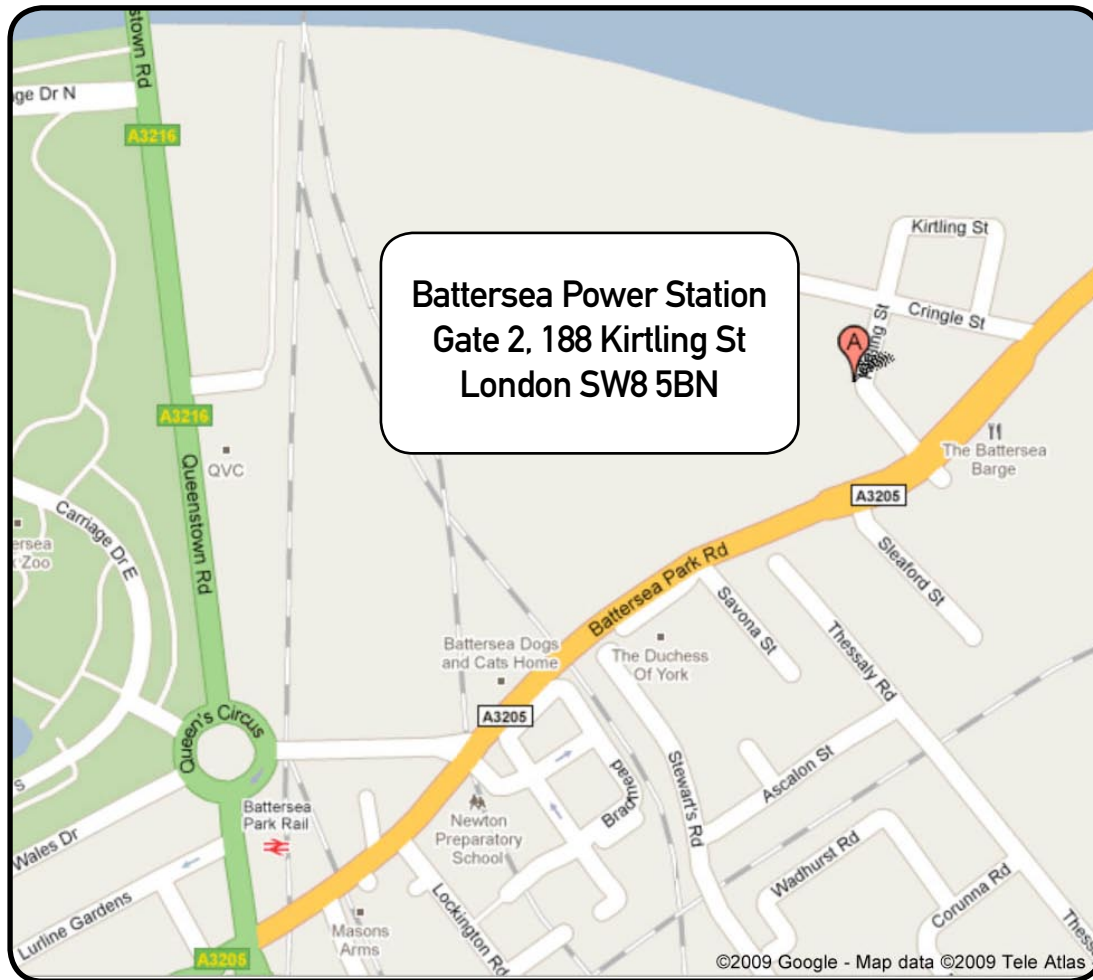

how to get there

by underground:

Vauxhall is the nearest tube station (Victoria line), then a 15-min bus journey (344 or 156 from bus stop E).

by rail:

Battersea Park Station (7-min walk) has overground links to Victoria and Clapham Junction. Kings Cross St Pancras (Eurostar) and Paddington Station (Heathrow Express) can both be reached within 30-40 minutes by public transport.

by road:

The entrance to Battersea Power Station is located on Kirtling Street, just off Battersea Park Road, which is easily accessible from all major routes into London. Onsite parking available with prior notification.

industri management Battersea site office:

Battersea Power Station
Gate 2, 188 Kirtling St
London SW8 5BN
tel: 020 7269 7935

Elias Devries
Director of Events and Location Filming
elias@industri.uk.com

Tarek Gjonnes
Director of Operations
tarek@industri.uk.com

Rachel Justice
Manager of Events & Location Filming
rachel@industri.uk.com

Paolo Bastiani
sales and events manager
paolo@industri.uk.com



suppliers accredited

battersea power station works with the best in the industry. through their individual expertise and their in-depth knowledge of our building, these carefully chosen suppliers deliver truly dynamic and creative events. only those suppliers on this list, all of whom comply with the relevant health and safety legislation, may be chosen to work at the power station. our accredited suppliers cover a wide range of styles and budgets, if you would like any help in choosing your suppliers, please contact our events team on 020 7269 7935 or email paolo@industri.uk.com.

catering

Admirable Crichton
020 7326 3800
Create
020 8944 4900
Fabulous Feasts
01869 365 795
Jackson Gilmour
020 8665 1855
Moving Venue
020 8691 6661
Mustard
020 8971 7800
Payne & Gunter
0870 850 1848
Rhubarb
020 8812 3200
Rocket
020 7622 2320
Table Talk
020 7401 3200
The Last Supper
020 7378 0101
The Recipe
0845 130 8087

speciality catering

Tony Page (Kosher)
020 8830 4000
Payal (Asian)
0845 009 5299
Greenleaf (Asian)
020 8574 0159

production

Event Concept
020 7740 3988
Fisher
020 8871 1978
Ingenius
020 8971 7888
Invisible Blue
020 7733 1144
Polar Bear Europe
020 7732 3377
S2
020 7928 5474
Star Events Group
01234 772 233
Starlight
020 8960 6078
White Light Productions
020 8254 4800
Wise Productions
020 8743 1122

bars

Creative Events Bars
020 7370 8686
Peppermint Bars
0845 226 7845

florists

Detta Phillips
020 7498 2728
Lavender Green
020 7127 5303
Pinstripes & Peonies
07739 808 695
Rob Van Helden
020 7720 6774
Wood Brown
020 7622 7501

marquee

Amazing Tents
01453 861 181
Arena
0800 3288 638
De Boer
01280 846 500
Neptunus
0845 180 4001

health & safety/acoustics

Capita Symonds
020 7808 4520

medical

Rescue Tech
07713 151 688
Event Paramedics
01480 457 404

photography

Rob Falconer
07879 404 595

security & stewarding

Ask the Events office for a quote

[click on any supplier's name to visit their website directly \(internet connection required\)](#)