

# Boiler House at Battersea Power Station

the power is back on at battersea

experience a dazzling evening in one of london's most iconic buildings; battersea power station is also one of london's most loved buildings. great architecture, its unique size and the history behind it make it an incredible sight.

the 2010 launch of the boiler house event venue inside the power station saw the the world-famous london landmark open its doors to indoor events for the very first time. in only months, the venue has firmly established itself as a red-carpet favourite. the unique boiler house at battersea power station is an adaptable venue for product launches, award ceremonies, private functions, fashion shows, charity balls, screenings, receptions, exhibitions and banqueting and more. recent major launches and events include call of duty: black ops and battersea dogs home's 150th anniversary gala with live performances from queen's brian may and roger taylor, roger daltrey and alexandra burke and staged the atp world tour finals tennis gala in 2011 with roger federer, rafael nadal and andy murray attending.

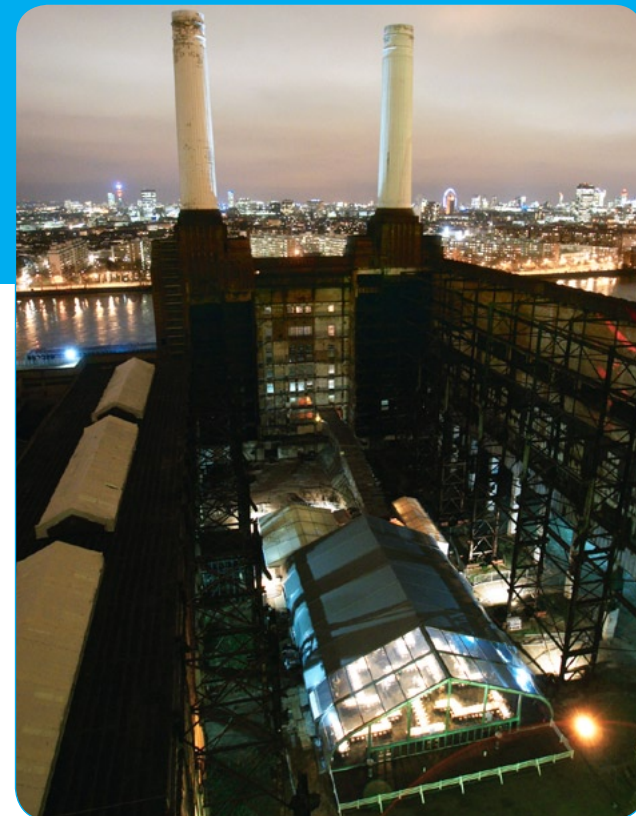

[click images to visit the boiler house web gallery](#)



a guide for hirers

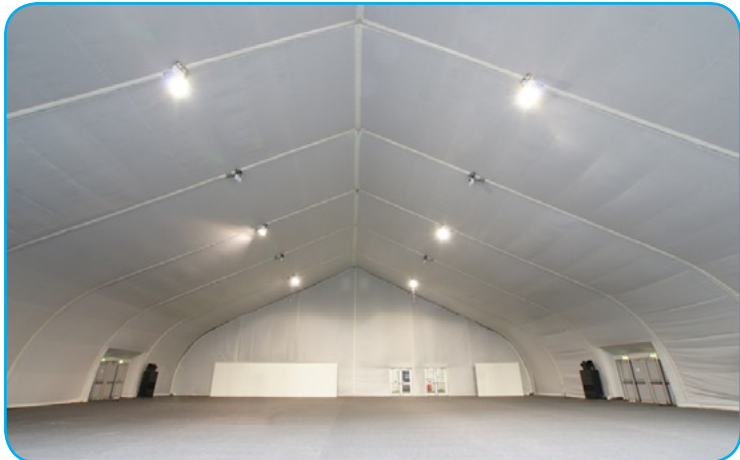

- **size:** main event space - 1,200 sqm/13,000 sqft, plus support areas, ceiling height of 12m/39ft
- **capacity:** from 500 sit down, 1000 standing
- **power/utilities:** 3phase, ac/heating available

**availability:**

monday - wednesday 11.00 - 24:00  
thursday - saturday 11.00 - 01.00

**other utilities:**

mains water supply available.

**access:**

vehicle and pedestrian access via gate 1  
on cringle street.

**parking:**

parking available for cars and coaches.

**branding:**

opportunity to project creative, dynamic  
branding and lighting on the internal  
elevations of the power station.

**kitchen:**

shell catering area - 225 sqm/740 sqft.

**reception:**

separate reception area and coatcheck.

**outdoors:**

viewing gallery and decked terrace  
overlooking 600 sqm/ 6458 sqft outdoor  
showcasing area.

**insurance:**

the hirer needs to provide  
public liability of £10,000,000.00,  
employer's liability of £10,000,000.00.

**WCS:**

serviced wc suites for 1000 available  
as standard.

# suppliers accredited

battersea power station works with the best in the industry. through their individual expertise and their in-depth knowledge of our building, these carefully chosen suppliers deliver truly dynamic and creative events. only those suppliers on this list, all of whom comply with the relevant health and safety legislation, may be chosen to work at the power station. our accredited suppliers cover a wide range of styles and budgets, if you would like any help in choosing your suppliers, please contact our events team on 020 7269 7935 or email [paolo@industri.uk.com](mailto:paolo@industri.uk.com).

## catering

**Admirable Crichton**  
020 7326 3800  
**Create**  
020 8944 4900  
**Fabulous Feasts**  
01869 365 795  
**Jackson Gilmour**  
020 8665 1855  
**Moving Venue**  
020 8691 6661  
**Mustard**  
020 8971 7800  
**Payne & Gunter**  
0870 850 1848  
**Rhubarb**  
020 8812 3200  
**Rocket**  
020 7622 2320  
**Table Talk**  
020 7401 3200  
**The Last Supper**  
020 7378 0101  
**The Recipe**  
0845 130 8087

## speciality catering

**Tony Page (Kosher)**  
020 8830 4000  
**Payal (Asian)**  
0845 009 5299  
**Greenleaf (Asian)**  
020 8574 0159

## production

**Event Concept**  
020 7740 3988  
**Fisher**  
020 8871 1978  
**Ingenius**  
020 8971 7888  
**Invisible Blue**  
020 7733 1144  
**Polar Bear Europe**  
020 7732 3377  
**S2**  
020 7928 5474  
**Star Events Group**  
01234 772 233  
**Starlight**  
020 8960 6078  
**White Light Productions**  
020 8254 4800  
**Wise Productions**  
020 8743 1122

## bars

**Creative Events Bars**  
020 7370 8686  
**Peppermint Bars**  
0845 226 7845

## florists

**Detta Phillips**  
020 7498 2728  
**Lavender Green**  
020 7127 5303  
**Pinstripes & Peonies**  
07739 808 695  
**Rob Van Helden**  
020 7720 6774  
**Wood Brown**  
020 7622 7501

## marquee

**Amazing Tents**  
01453 861 181  
**Arena**  
0800 3288 638  
**De Boer**  
01280 846 500  
**Neptunus**  
0845 180 4001

## health & safety/acoustics

**Capita Symonds**  
020 7808 4520

## medical

**Rescue Tech**  
07713 151 688  
**Event Paramedics**  
01480 457 404

## photography

**Rob Falconer**  
07879 404 595

## security & stewarding

Ask the Events office for a quote

[click on any supplier's name to visit their website directly \(internet connection required\)](#)



## we're here to help:

battersea power station is a grade II listed heritage building. staging an event in the boiler house may require a variety of permissions and conditions to be met and specific documentation to be secured. industri has steered and assisted many clients through the processes involved in staging events on the site. we are on hand to guide you, put you directly in touch with any required third parties and assist you where needed. please contact our events team on 020 7269 7935 or email [paolo@industri.uk.com](mailto:paolo@industri.uk.com) with any initial queries you may have.

## hire type:

all event facilities are available on a dry hire basis only.

## contracts:

event facilities are hired subject to battersea power station's standard licence agreement. a thorough schedule of hire will be required for each event. a standard template will be supplied and will form part of the licence agreement.

## health & safety:

all hirers will be required to provide health & safety documentation for their event. a venue safety management plan is available for the boiler house, subject to the hirer providing bespoke amendments according to its event specifications.

## advertising and promotion:

all hirers must submit advertising and promotional material in relation to their event for landowner approval in advance of release to the public domain.

## damage deposit:

will be required prior to any event. the value will vary depending on the event activity, length of hire and area being used.

## fees:

all fees will be subject to a strict payment schedule and due in full in advance of the event.

## permissions:

planning permission and premise licence secured for the boiler house venue.

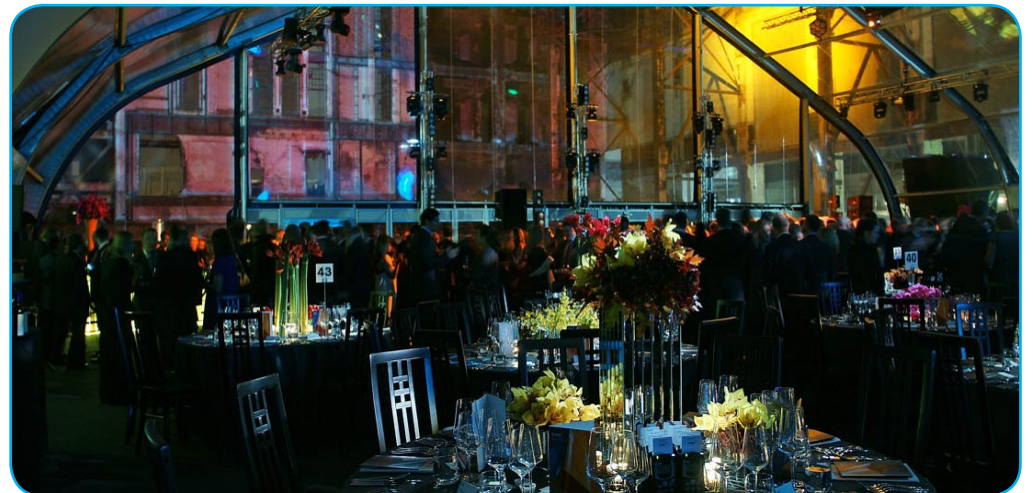

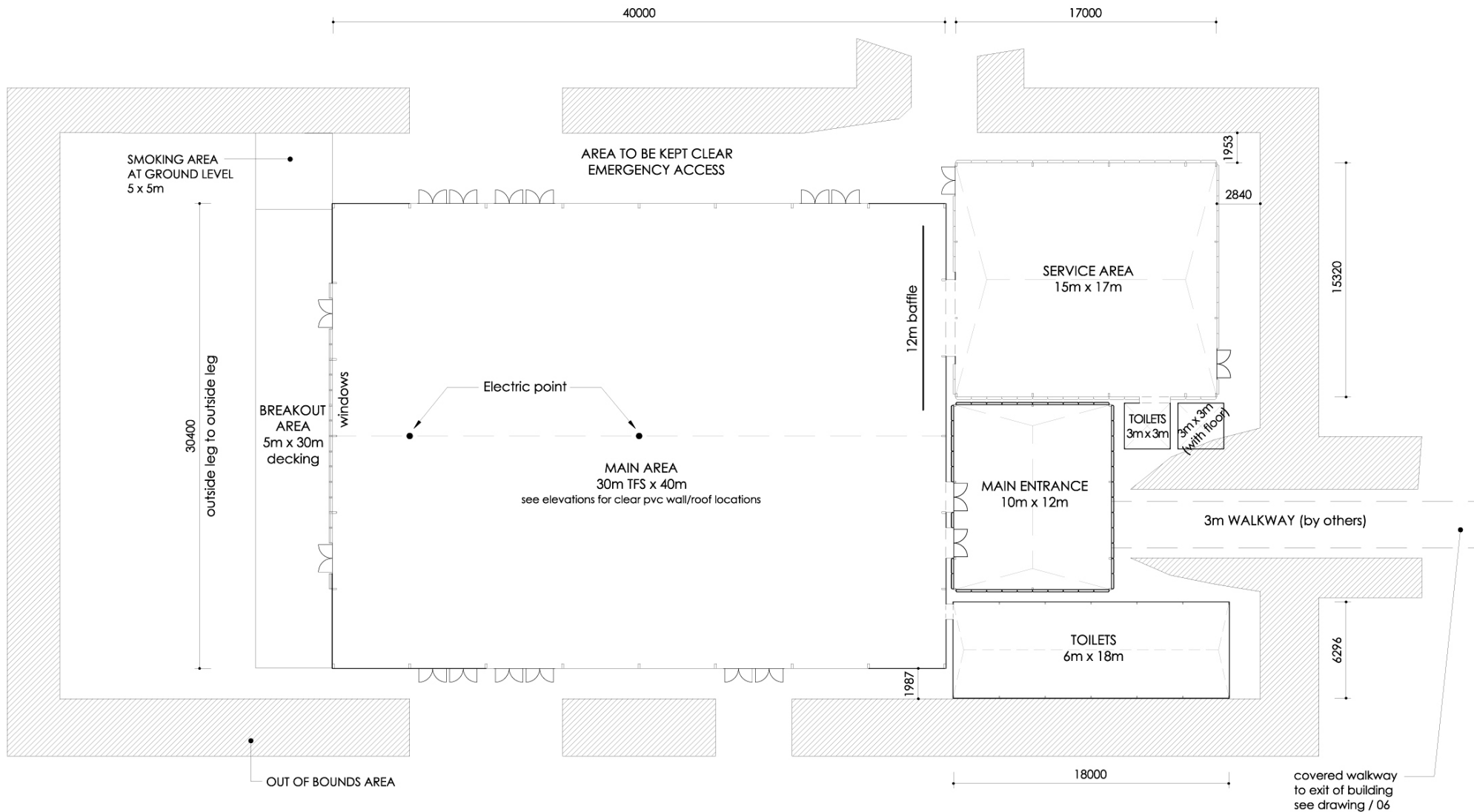

0 2.5 5

SCALE IN METRES

floorplan

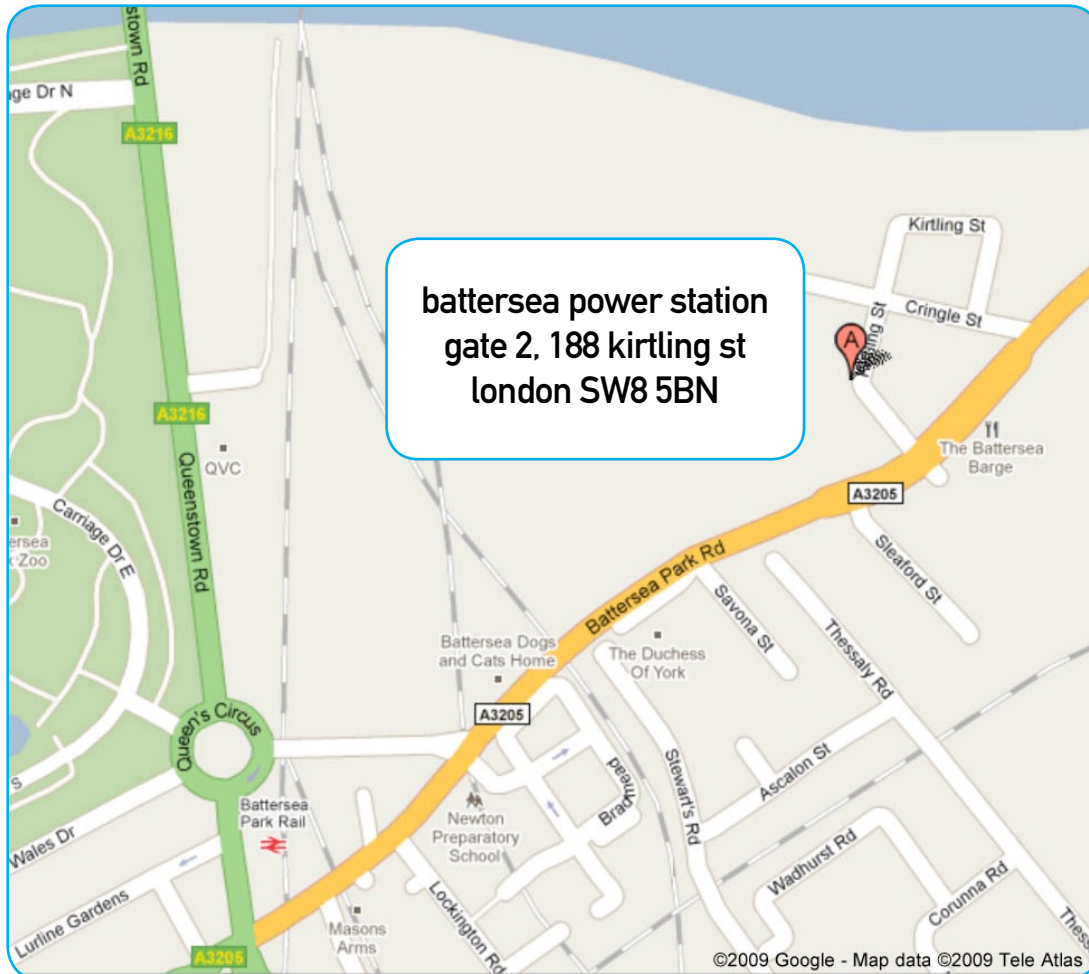

(click address to email)

Paolo Bastiani  
sales and events manager  
[paolo@industri.uk.com](mailto:paolo@industri.uk.com)

## how to get there

by underground:

vauxhall is the nearest tube station (victoria line), then a 15-min bus journey (344 or 156 from bus stop e).

by rail:

battersea park Station (7-min walk) has overground links to victoria and clapham junction. kings cross st pancras (eurostar) and paddington station (heathrow express) can both be reached within 30-40 minutes by public transport.

by road:

the entrance to battersea power station is located on kirtling street, just off battersea park road, which is easily accessible from all major routes into london. onsite parking available with prior notification.

[industri management battersea site office:](#)

battersea power station  
gate 2, 188 kirtling st  
london SW8 5BN  
tel: 020 7269 7935



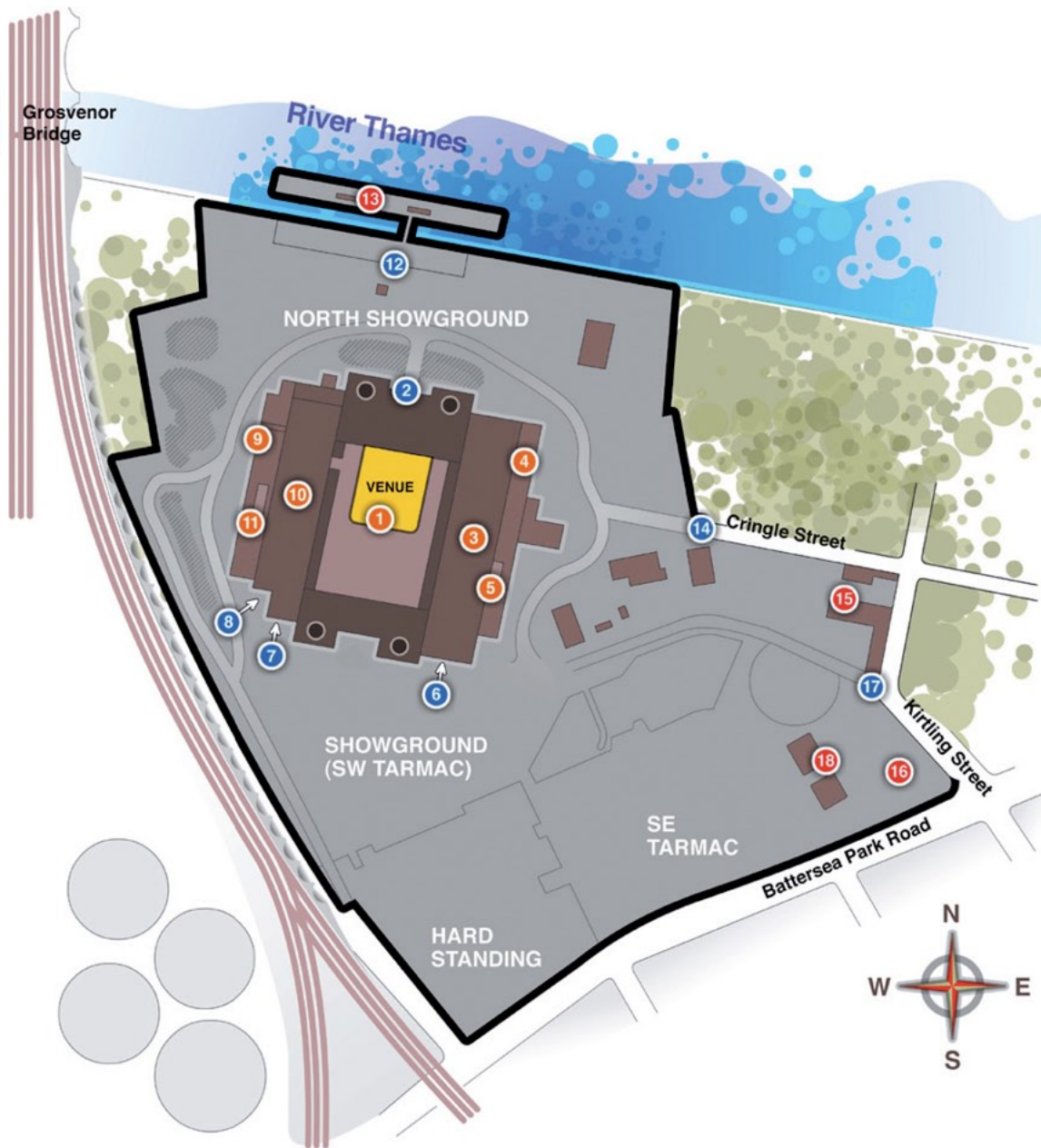

- 1 Boiler House
- 3 Turbine Hall
- 4 Annexe B
- 5 Control Room B
- 9 Annexe A
- 10 Turbine Hall A
- 11 Control Room A
  
- 2 access into Boiler House
- 6 access into Turbine Hall B
- 7 access into Turbine Hall A
- 8 access into Annexe A
- 12 access to jetty
- 14 gate 1
- 17 gate 2 main entrance & security lodge
  
- 13 jetty with coal cranes
- 15 offices
- 16 visitors car park
- 18 The View

battersea power station site plan